

Soils Map

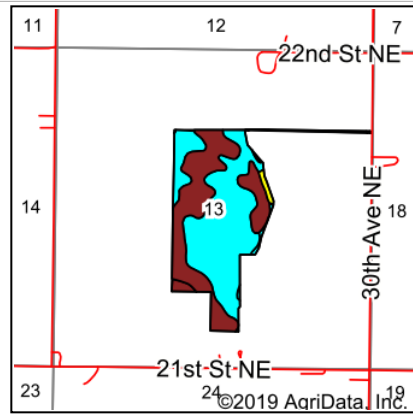

State: **North Dakota**
 County: **Wells**
 Location: **13-149N-73W**
 Township: **Western**
 Acres: **94.72**
 Date: **4/26/2019**

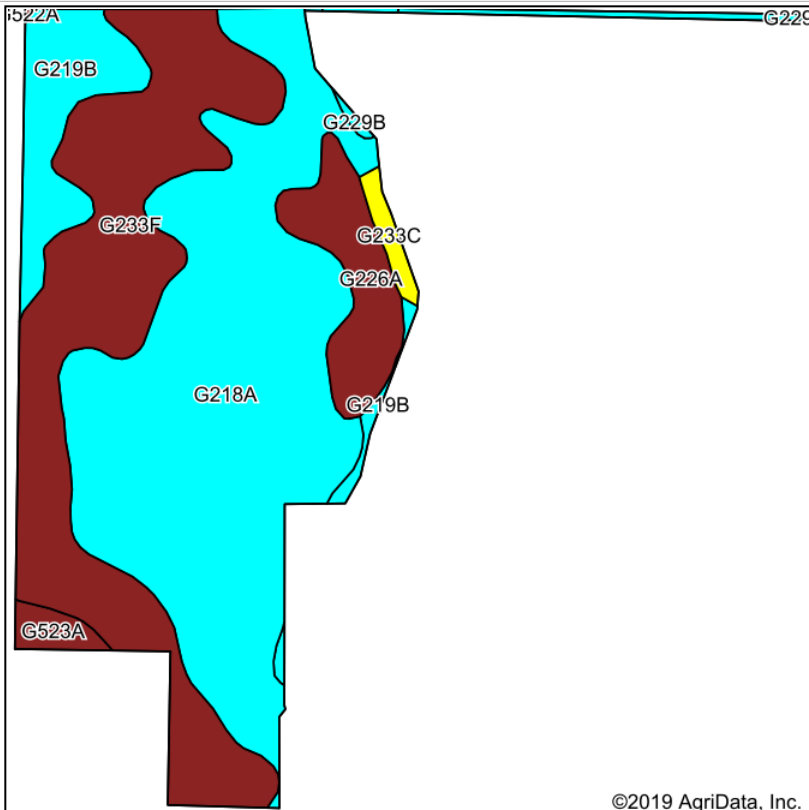

Maps Provided By:

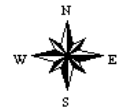

Soils data provided by USDA and NRCS.

©2019 AgriData, Inc.

© AgriData, Inc. 2019

www.AgriDataInc.com

Area Symbol: ND103, Soil Area Version: 20

Code	Soil Description	Acres	Percent of field	Non-Irr Class Legend	Non-Irr Class *c	Productivity Index
G218A	Emrick-Larson loams, 0 to 3 percent slopes	48.06	50.7%		Ile	63
G233F	Esmond-Heimdal-Darner loams, 9 to 35 percent slopes	29.52	31.2%		VIIe	32
G219B	Heimdal-Larson loams, 3 to 6 percent slopes	8.06	8.5%		Ile	59
G226A	Uranda-Larson loams, 0 to 3 percent slopes	6.43	6.8%		VI s	48
G523A	Lowe-Fluvaquents, channeled complex, 0 to 2 percent slopes, frequently flooded	1.30	1.4%		VI w	21
G233C	Esmond-Heimdal-Darner loams, 3 to 9 percent slopes	1.04	1.1%		IV e	61
G229B	Heimdal-Emrick loams, 3 to 6 percent slopes	0.31	0.3%		Ile	72
Weighted Average						51.4

*c: Using Capabilities Class Dominant Condition Aggregation Method

Soils data provided by USDA and NRCS.